

## RATCHET CRIMPING PLIERS

## PAR-20

*Crimping wire and sheath simultaneously by a single gripping*



Ratchet releaser



Twin crimping of both conductor and sheath portions made at the same time

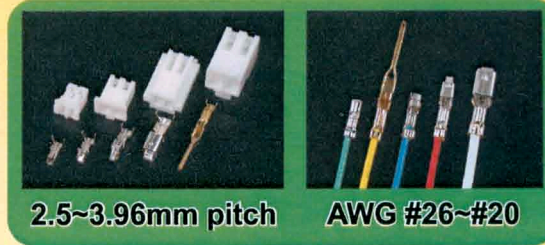

2.5~3.96mm pitch

AWG #26~#20

High accurate dies for fine crimping finish

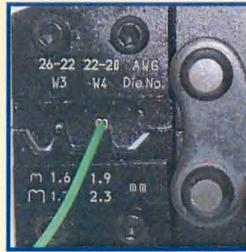

Ratchet mechanism ensures uniform and completely-precise crimping.

Handle sleeve made of PP, good for chemical resistance

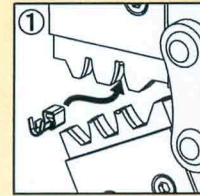

Put a contact pin on to an adaptable die and close jaws just a little to hold the contact.

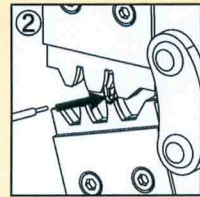

Insert the lead wire into the barrel of contact.

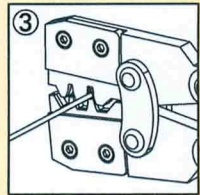

Grip the handles steadily and further until the ratchet is released.

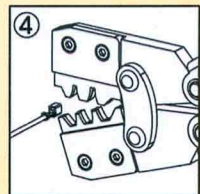

The jaws are opened to finish crimping.

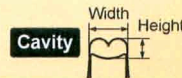
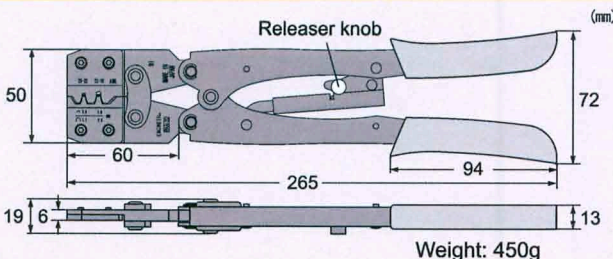

Application table

Die No.	Die Width	Die Height	Die Thickness	Applicable wire size (Reference)		
				φ mm	mm <sup>2</sup>	AWG (Conductor)
W3	Conductor 1.6mm	0.7mm	1.5mm	0.41~0.64	0.13~0.33	#26~#22
	Sheath 1.7mm	1.7mm	2.5mm			
W4	Conductor 1.9mm	0.9mm	1.5mm	0.64~0.81	0.33~0.52	#22~#20
	Sheath 2.3mm	2.5mm	2.5mm			



Manufacturer  
**ENGINEER INC.**

2-8-9 Higashi-Imazato, Higashinari-ku  
Osaka 537-0011, Japan

☎ (81) 6-6974-0028 FAX (81) 6-6974-5661

URL <http://www.engineer.jp>