

THICK FILM CERMET ROTARY POTENTIOMETER TYPE CW18

Description

CW18 is a thick film layer resistance track fitted on a ceramic base. The actuating device is an isolated rotor with a carbon wiper, operated by a metal spindle. The resistance element is shielded by a metal housing. The housing is profiled to act as a heatsink.

The terminal a and c (see Fig.) are the end terminals; b is the central terminal connected to the slider. All terminals are either solder tags.

CW18 potentiometers can be manufactured as standard or hermetic version.

Application

CW18 potentiometers are for control functions where high dissipation and high stability are necessary, in industrial control functions.

Quick reference data

Resistance range:	100 to 2.2M Ω ,
Power dissipation:	1 W,
Limiting voltage:	300 V
Climatic category:	55/100/55

Parameters

Parameter	Unit	Value
Rated resistance R_N		According to the series 1 – 1.5 – 2.2 – 3.3 – 4.7 – 6.8 – 8 – 10 etc.
Resistance range:	Ω	100 ÷ 2.2 M
Resistance tolerance:		
for resistance up to 470 k Ω	%	± 20
for resistance higher than 470 k Ω		± 30
Characteristic A:		linear
Temperature Coefficient of Resistance TCR:	ppm/ $^{\circ}$ C	± 300
Power dissipation P_N at 55 $^{\circ}$ C:	W	1
Limiting voltage	V	350
Operating torque:	mNm	≤ 40
Climatic category	-	55/100/56

Outline view - dimensions

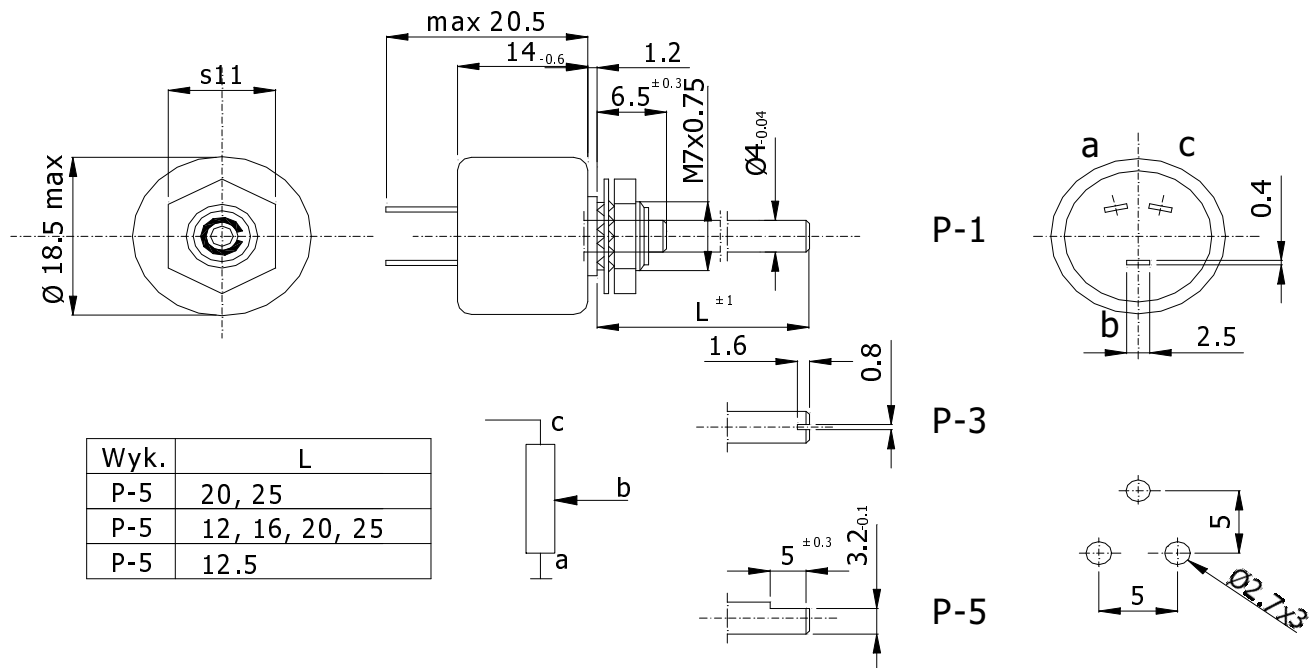

Ordering information:

Please specify in order:

1. Type of potentiometer (CW18); resistance value; shaft length; shaft end (P1, P3, P5):

Example: **CW18 47 k Ω 20 P-3**

2. Type of potentiometer (CW18); resistance value; shaft length; shaft end (P1, P3, P5)
hermetic version:

Example: **CW18H 47 k Ω A 20 P-3**

Packaging:

In plastic bags and cartons.

Trade and technical information:

- engineering:

Technical Division

phone: +48 (0)12 257 10 12

- trade:

Sale Division

phone: +48 (0)12 257 10 35

fax: +48 (0)12 257 10 13

Email: telpod@telpod.krakow.pl

www.telpod.krakow.pl

TELPOD S.A.

ul. Lipowa 4; 30-702 KRAKÓW; POLAND
Phone: 0048 12 257 10 11; Fax: 0048 12 257 10 13;
e-mail: telpod@telpod.krakow.pl