

REFER TO PAGE 6 FOR PART DIMENSIONS

NOTE: ALL MOUNTING DIMENSIONS ARE FOR REFERENCE ONLY. VERIFY YOUR BATTERY LAYOUT PRIOR TO FABRICATION.

FIGURE 5



Mounting Detail

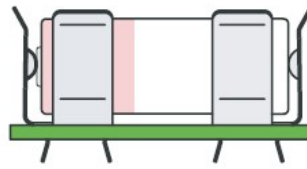
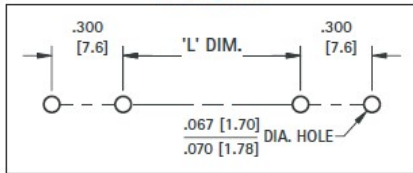

82
92
2915

52

CAT. NO.	L DIMENSION		
	For "AAA"	For "N"	For 12 VOLT
82 with 82	1.080 (27.4)	.510 (13.0)	.450 (11.4)

CAT. NO.	L DIMENSION						
	For "A"	For "4/5A"	For "2/3A"	For "1/2A"	For "AA"	For "4/5AA"	For "1/2AA"
52 with 52	1.120 (28.5)	1.020 (25.9)	.645 (16.4)	.300 (7.6)	1.320 (33.5)	1.020 (25.9)	.300 (7.6)
92 with 92	1.120 (1.12)	1.020 (25.9)	.645 (16.4)	.300 (7.6)	1.320 (33.5)	1.020 (25.9)	.300 (7.6)
2915 with 2915	1.120 (1.12)	1.020 (25.9)	.645 (16.4)	.300 (7.6)	1.320 (33.5)	1.020 (25.9)	.300 (7.6)

FIGURE 6



Mounting Detail

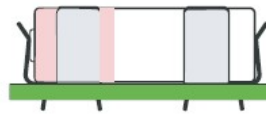
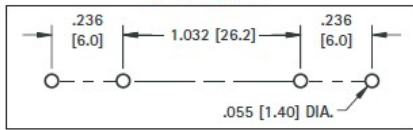

51

CAT. NO.	L DIMENSION
	For "AAAA"
51 with 51	1.032 (26.2)

FIGURE 7



Pad Layout

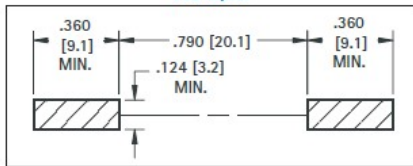

50

CAT. NO.	L DIMENSION
	For "AAAA"
50 with 50	1.032 (26.2)

FIGURE 8



Pad Layout

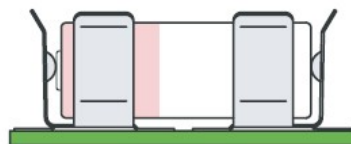
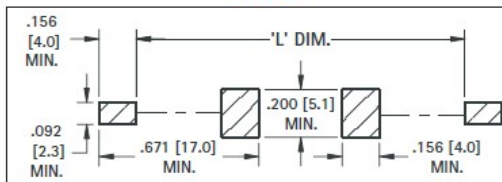

55

CAT. NO.	L DIMENSION		
	For "A"	For "4/5A"	For "2/3A"
55 with 55	1.880 (47.8)	1.280 (32.5)	1.220 (31.0)

FIGURE 9



Mounting Detail

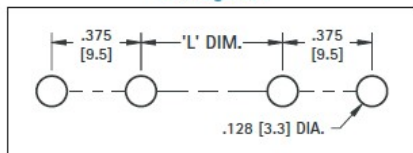

206

207
208

CAT. NO.	L DIMENSION
	For "AA"
206 with 206	1.100 (27.9)

CAT. NO.	L DIMENSION
	For "C"
207 with 207	.812 (20.6)

CAT. NO.	L DIMENSION
	For "D"
208 with 208	1.250 (31.8)

REFER TO PAGE 7 FOR PART DIMENSIONS

NOTE: ALL MOUNTING DIMENSIONS ARE FOR REFERENCE ONLY. PLEASE VERIFY YOUR BATTERY LAYOUT PRIOR TO FABRICATION.

BATTERY CONTACTS LAYOUT & MOUNTING DETAILS



204
209



202
288
210



290
291



228
238



292
294

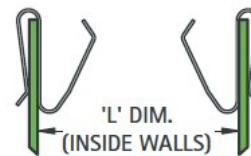

FIGURE 10

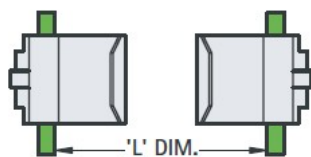

FIGURE 11

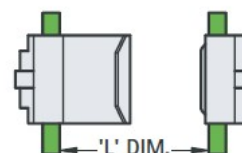

FIGURE 12

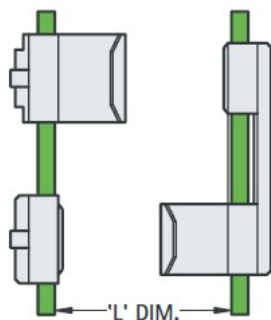

FIGURE 13

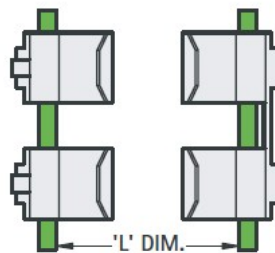
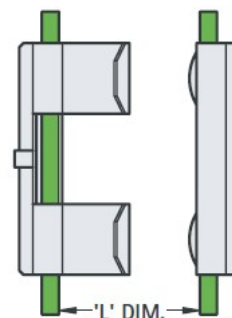

FIGURE 14



CAT. NO.	FIG NO.	L DIMENSION			
		For "AAAA"	For "AAA"	For "N"	For 12 VOLT
204 with 204	10	1.860 (47.2)	1.964 (49.9)	1.390 (35.3)	1.330 (33.8)
204 with 238	11	1.790 (45.5)	1.870 (47.5)	1.300 (33.0)	1.240 (31.5)
204 with 294	11	1.790 (45.5)	1.870 (47.5)	1.300 (33.0)	1.240 (31.5)
204 (2) with 202	13	1.860 (47.2)	1.964 (49.9)	1.390 (35.3)	1.330 (33.8)
202 with 294	14	1.790 (45.5)	1.870 (47.5)	1.300 (33.0)	1.240 (31.5)

CAT. NO.	FIG NO.	L DIMENSION				
		For "A"	For "4/5A" & "4/5AA"	For "2/3A"	For "1/2A" & "1/2AA"	For "AA"
209 with 209	10	2.090 (53.1)	1.990 (50.6)	1.620 (41.2)	1.270 (32.3)	2.270 (57.7)
209 with 228	11	1.950 (49.5)	1.850 (47.0)	1.480 (37.6)	1.130 (28.7)	2.130 (54.1)
209, 228 with 290	12	1.950 (49.5)	1.850 (47.0)	1.480 (37.6)	1.130 (28.7)	2.130 (54.1)
209, 228 with 291	12	1.950 (49.5)	1.850 (47.0)	1.480 (37.6)	1.130 (28.7)	2.130 (54.1)
209 (2) with 288	13	2.090 (53.1)	1.990 (50.6)	1.620 (41.2)	1.270 (32.3)	2.270 (57.7)
209 (2) with 210	13	2.090 (53.1)	1.990 (50.6)	1.620 (41.2)	1.270 (32.3)	2.270 (57.7)
210 with 292	14	1.980 (50.3)	1.880 (47.8)	1.500 (38.1)	1.150 (29.2)	2.160 (54.9)

Suggested wall thickness: .062 (1.57) through .078 (1.98)

FIGURE 15

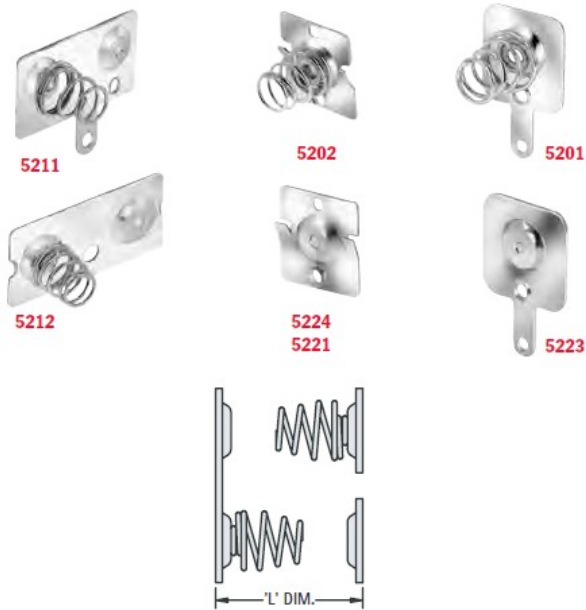

FIGURE 16



FIGURE 17



FIGURE 18

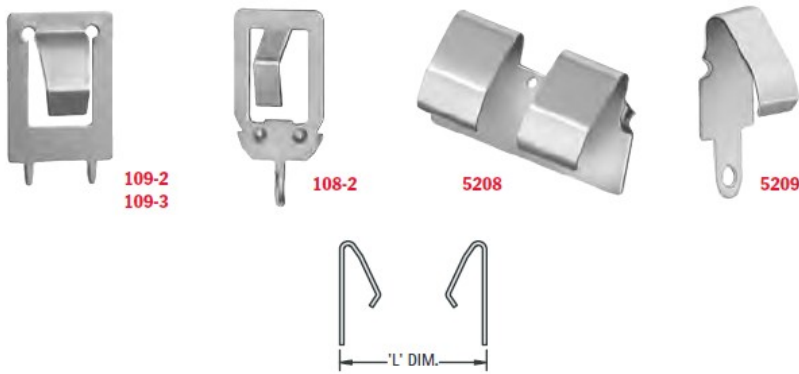
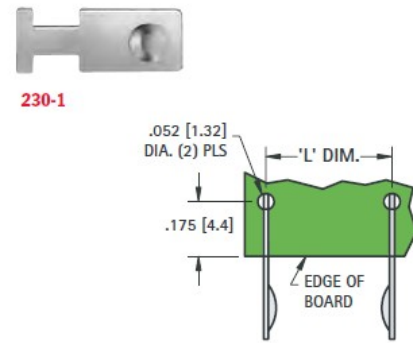

FIGURE 19



CAT. NO.	FIG NO.	PAGE NO.	"L" DIMENSION				
			For "A"	For "4/5A" "4/5AA"	For "2/3A"	For "1/2A" "1/2AA"	For "AA"
5211 with 5201, 5223	15	8	2.070 (52.58)	1.970 (50.04)	1.600 (40.64)	1.250 (31.75)	2.250 (57.15)
5212 with 5221, 5222	15	8	2.070 (52.58)	1.970 (50.04)	1.600 (40.64)	1.250 (31.75)	2.250 (57.15)
5227 with 5228	16	8	2.070 (52.58)	1.970 (50.04)	1.600 (40.64)	1.250 (31.75)	2.250 (57.15)
5224 with 5202	17	8	2.080 (52.83)	1.980 (50.29)	1.610 (40.89)	1.260 (32.00)	2.260 (57.40)
5223 with 5201	17	8	2.070 (52.58)	1.970 (50.04)	1.600 (40.64)	1.250 (31.75)	2.250 (57.15)
5221 with 5222	17	8	2.070 (52.58)	1.970 (50.04)	1.600 (40.64)	1.250 (31.75)	2.250 (57.15)
5208 with 5209, 5209	18	9	2.280 (57.91)	2.180 (55.37)	1.810 (45.97)	1.460 (37.08)	2.460 (62.48)
5209 with 5209	18	9	2.280 (57.91)	2.180 (55.37)	1.810 (45.97)	1.460 (37.08)	2.460 (62.48)
108-2 with 108-2	18	9	1.990 (50.55)	1.890 (48.01)	1.520 (38.61)	1.170 (29.72)	2.170 (55.12)
109-2 with 109-2	18	9	1.990 (50.55)	1.890 (48.01)	1.520 (38.61)	1.170 (29.72)	2.170 (55.12)
109-3 with 109-3	18	9	1.990 (50.55)	1.890 (48.01)	1.520 (38.61)	1.170 (29.72)	2.170 (55.12)

CAT. NO.	FIG. NO.	PAGE NO.	"L" DIMENSION			
			For "AAAA"	For "AAA"	For "N"	For 12 VOLT
5214 with 5225, 5203	15	9	1.880 (47.75)	1.980 (50.29)	1.380 (35.05)	1.320 (33.53)
5213 with 5203, 5225	15	9	1.880 (47.75)	1.980 (50.29)	1.380 (35.05)	1.320 (33.53)
5226 with 5204	17	9	1.880 (47.75)	1.980 (50.29)	1.380 (35.05)	1.320 (33.53)
5225 with 5203	17	9	1.880 (47.75)	1.980 (50.29)	1.380 (35.05)	1.320 (33.53)
108-2 with 108-2	18	9	1.840 (46.74)	1.940 (49.28)	1.340 (34.04)	1.280 (32.51)
230-1 with 230-1	19	9	1.642 (41.71)	1.732 (43.99)	1.142 (29.01)	1.102 (27.99)