

# JACK SCREWS

- Equivalent to AMP, CANNON & TRW Jack Screws
  - "D" subminiature connector mounting screw
  - Custom lengths available
  - Hardware supplied unassembled and in bulk
- SPECIFICATIONS:** **GOLD:** Steel, Zinc Plate and Yellow Dye; **CLEAR:** Steel, Zinc Plate and Clear Chromate; **STAINLESS:** Stainless Steel

## STANDARD JACK SCREWS

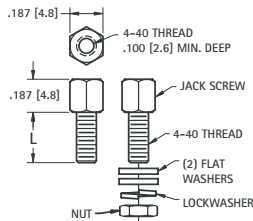

## SEMS JACK SCREWS

- Captivated helical spring lockwasher, simplifies use

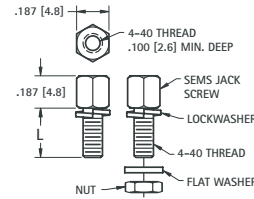

JACK ONLY			L LENGTH	JACK WITH HARDWARE*		
GOLD CAT. NO.	CLEAR CAT. NO.	STAINLESS CAT. NO.		GOLD CAT. NO.	CLEAR CAT. NO.	STAINLESS CAT. NO.
7228	7228-5	7248	.250 (6.4)	7229	7229-5	7249
7230	7230-5	7250	.312 (7.9)	7231	7231-5	7251
7241	7241-5	7252	.375 (9.5)	7242	7242-5	7253
7243	7243-5	7254	.500 (12.7)	7244	7244-5	7255
7232	7232-5	7256	.625 (15.8)	7233	7233-5	7257

\*Hardware supplied unassembled in bulk

SEMS JACK ONLY		L LENGTH	SEMS JACK WITH HARDWARE*	
CLEAR CAT. NO.	CLEAR CAT. NO.		CLEAR CAT. NO.	CLEAR CAT. NO.
7235	7236	.285 (7.3)	7237	7238
7237	7238	.347 (8.8)	7239	7240
7239	7240	.660 (16.8)		

\*Hardware supplied unassembled in bulk

## SLOTTED JACK SCREWS

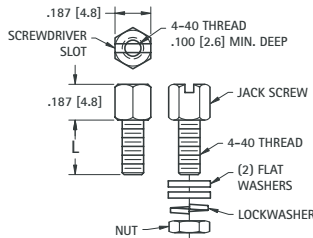

- Slot provides ability to install jack with a screwdriver.

JACK ONLY			L LENGTH	JACK WITH HARDWARE*	
GOLD CAT. NO.	CLEAR CAT. NO.	CLEAR CAT. NO.		GOLD CAT. NO.	CLEAR CAT. NO.
7270	7275	7290	.250 (6.3)	7291	7295
7271	7276	7292	.312 (7.9)	7293	7296
7272	7277	7294	.375 (9.5)	7295	7297
7273	7278	7296	.500 (12.7)	7297	7298
7274	7279	7298	.625 (15.8)	7298	7299

\*Hardware supplied unassembled in bulk

## JACK SCREWS WITH NYLON PATCH

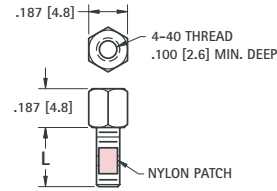

- Nylon patch holds jack firmly in vibration applications.

JACK WITH NYLON PATCH			
GOLD CAT. NO.	CLEAR CAT. NO.	STAINLESS CAT. NO.	L LENGTH
7260	7261	7262	.250 (6.4)
7263	7264	7265	.312 (7.9)
7266	7267	7268	.375 (9.5)

# TURNABLE JACK SCREWS

## DIRECT ACCESS

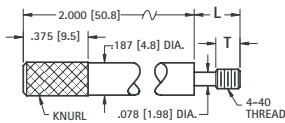

**MATERIAL:** Steel, Black Oxide

WITHOUT SLOT CAT. NO.	WITH SLOT CAT. NO.	T DIM.	L DIM.
2064	2065	.125 (3.2)	.250 (6.4)
2066	2067	.250 (6.4)	.437 (11.1)

## STRAIGHT KNURL

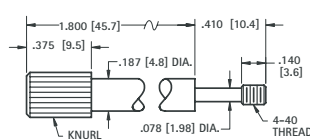

**MATERIAL:** Steel, Zinc Plate & Clear Chromate

WITHOUT SLOT CAT. NO.	WITH SLOT CAT. NO.
2072	2073

## SLIM LINE

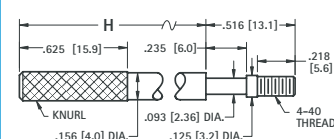

**MATERIAL:** Steel, Nickel Plate

WITHOUT SLOT CAT. NO.	WITH SLOT CAT. NO.	H DIM.
2068	2069	1.250 (31.8)
2070	2071	1.750 (44.5)

# PANEL MOUNTING HARDWARE

## "U" CLIP



Supplied Unassembled

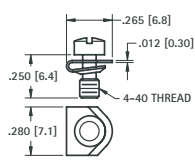

**MATERIAL:**  
Clip & Screw: Steel, Zinc Plate & Yellow Dye

**CAT. NO. 2062**

## "BOW TIE" RETAINING CLIP



Supplied Unassembled

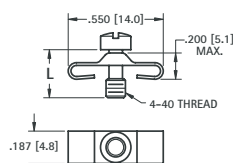

**MATERIAL:**  
Clip & Screw: Steel, Zinc Plate & Yellow Dye

CAT. NO.	L
2060	.250 (6.4)
2061	.281 (7.1)

## SADDLE WASHER



Supplied Unassembled

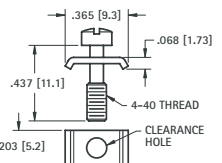

**MATERIAL:**  
Clip & Screw: Steel, Zinc Plate & Yellow Dye

**CAT. NO. 2063**