

## Inductive proximity switch

## IFRM 12P1703/S14L

## dimension drawing

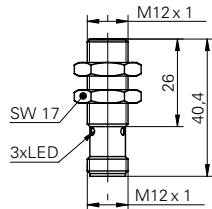

## general data

|                                |                     |
|--------------------------------|---------------------|
| mounting type                  | shielded            |
| nominal sensing distance $S_n$ | 4 mm                |
| hysteresis                     | 3 ... 20 % of $S_r$ |
| output indicator               | 3 port LED red      |

## electrical data

|                             |                        |
|-----------------------------|------------------------|
| switching frequency         | < 2 kHz                |
| voltage supply range +Vs    | 10 ... 30 VDC          |
| current consumption max.    | 10 mA                  |
| output circuit              | PNP make function (NO) |
| voltage drop $V_d$          | < 2 VDC                |
| output current              | < 200 mA               |
| short circuit protection    | yes                    |
| reverse polarity protection | yes                    |

## mechanical data

|                         |                      |
|-------------------------|----------------------|
| type                    | cylindrical threaded |
| material (sensing face) | PBT                  |
| housing material        | brass nickel plated  |
| dimension               | 12 mm                |
| housing length          | 40,4 mm              |
| connection types        | connector M12        |

## ambient conditions

|                       |                |
|-----------------------|----------------|
| operating temperature | -25 ... +75 °C |
| protection class      | IP 67          |

## photo



## connection diagram

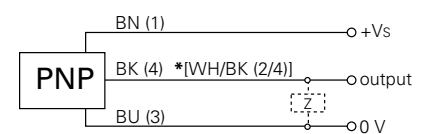

\* .../S14L pin 2 & 4 electrically connected