

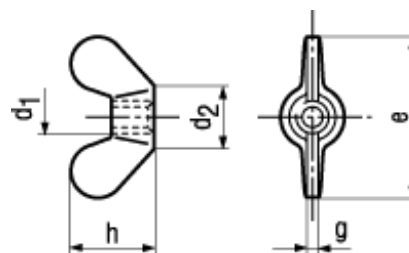

DIN 315



BN 208

Wing nuts

Malleable cast iron / steel

zinc plated blue

- ~UNI 5448 B
- ~CSN 021665



Material at manufacturer's option

M14: not included in DIN 315

Article#	d ₁	d ₂ max.	e max.	g max.	h max.
1099167	M4	8	20	1,9	10,5
1099175	M5	11	26	2,3	13
1099183	M6	13	33	2,3	17
1099191	M8	16	39	2,8	20
1099205	M10	20	51	4,4	25
1099213	M12	23	65	4,9	33,5
1099221	M14	23	65	4,9	33,5
1099248	M16	29	73	6,4	37,5
1429760	M20	35	90	6,9	46,5
1429779	M24	44	110	9,4	56,5