

## BN 351

Slotted pan head screws

DIN 85 A  
~ISO 1580  
~UNI 6108

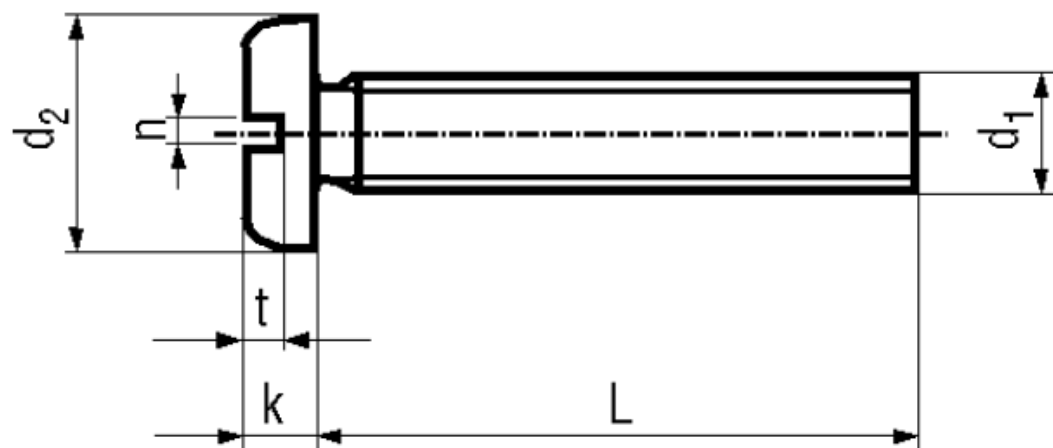

Material	<b>Steel</b>	Tensile strength	<b>800 N/mm2</b>
Surface	<b>zinc plated blue</b>	Proof stress 0,2%	<b>640 N/mm2</b>
Quality	<b>8.8</b>	Elongation after fracture	<b>min. 12%</b>

### Article No. - 1135120

d <sub>1</sub>	M6
L	16
d <sub>2</sub>	12
k max.	3,6
n	1,6
t min.	1,4
Proof load (N)	11600

DIN 85 A: Standard withdrawn  
M2,5 to ISO 1580  
All lengths fully threaded.