

BN 3333

Cross recessed flat countersunk
head screws
Pozidriv Z

DIN 965 A
~ISO 7046
~UNI 7688

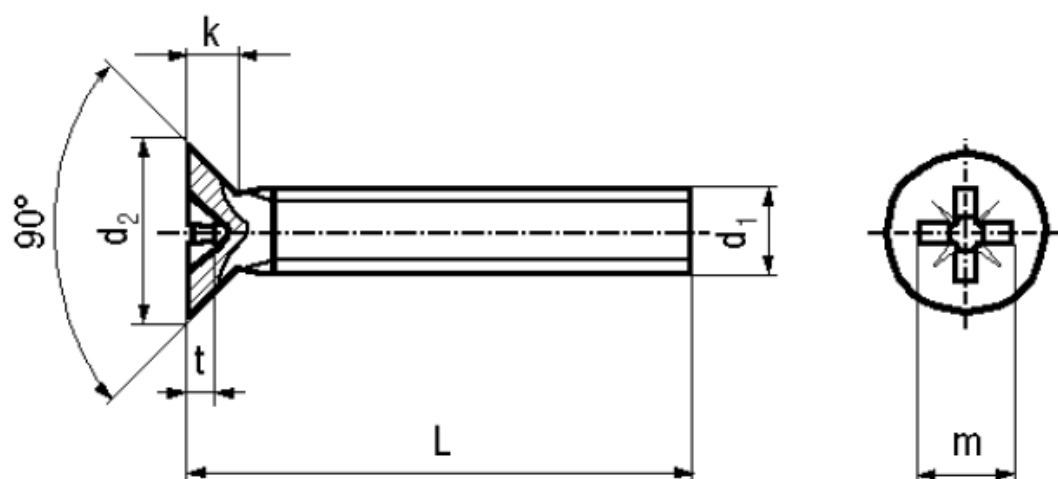

Material	Steel	Quality	4.8
Surface	zinc plated blue	Tensile strength	400 N/mm ²

Article No. - 1536915

d ₁	M2,5
L	12
d ₂ max.	4,7
k max.	1,5
Pozidriv	1
m~	2,5
t min.	1,22
t max.	1,47

DIN 965 A: Standard withdrawn
DIN 965 A Phillips cross recess (Type H) see BN 388, BN 8167.
All lengths fully threaded.